

Tufftalk M Hard Hat Mount Earmuff Quick Start Guide

ENGLISH

Ride Connected

Blast your favorite tunes, talk over the intercom with your buddies, all through your headset. With built-in Bluetooth® capabilities, Audio Multitasking™, HD speakers and a microphone using Advanced Noise Control™, technology has never felt so minimal or freeing.

ATTENUATION 24 dB

BLUETOOTH 4.1

**MESH INTERCOM™
1.1 KM / 0.7 MILES***

**INTERCOM
400 M / 430 YARDS***

**MULTI-WAY
INTERCOM**

AUDIO MULTITASKING™

MUSIC SHARING

**ADVANCED NOISE
CONTROL**

* in open terrain

Getting Started

1. This product comes with a Quick Start Guide, which is a basic version of the User's Guide. **A FULL VERSION OF THE USER'S GUIDE CAN BE DOWNLOADED AT SENA.COM.**
2. Update this product for free with the latest firmware to fully enjoy the new advanced features built into this product. Visit sena.com to see how to update your product.
3. Users can follow Sena on Facebook, YouTube, Twitter and Instagram to receive the most up to date information on products, helpful tips and all other announcements regarding Sena products.

SENA
Sena Technologies, Inc.
www.sena.com
Customer Support: support.sena.com

Installation

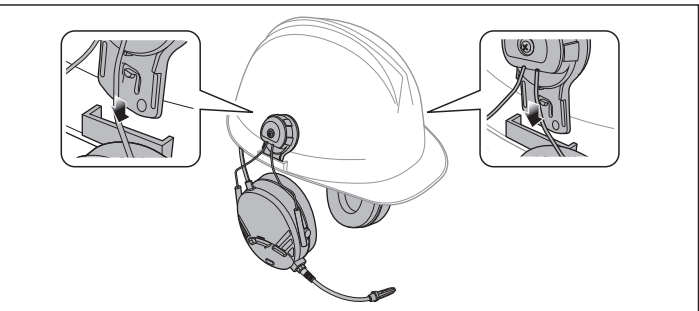

Installing the Microphone

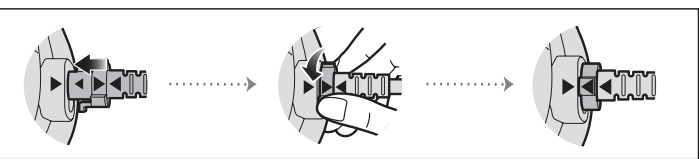

Replacing the Ear Pads of the Tufftalk M

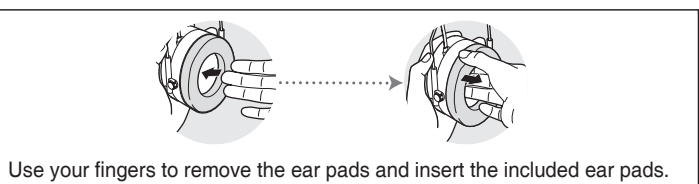

Charging

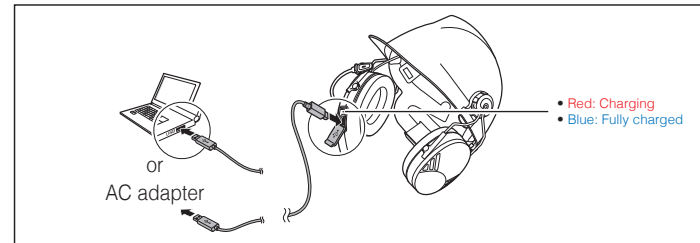

Sena Utility App

- By simply pairing your phone with your headset, you can use the **Sena Utility App** for quicker and easier set up and management.
- App Features
 - Music, FM Radio, Device settings, Quick Start Guide, and User's Guide.
 - Download
 - Android: Google Play Store > 'Sena Utility'
 - iOS: App Store > 'Sena Utility'

Sena Device Manager

The **Sena Device Manager** allows you to upgrade the firmware and configure its settings directly from your PC or Apple computer. Download the **Sena Device Manager** from sena.com.

Button Operation

- ← Tap Tapping
- ←← Tap Double Tapping
- ← 1" Press for 1 sec
- ← 5" 10" Press and Hold

Power On/Off

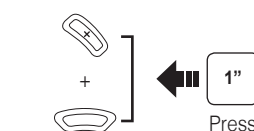

Volume Adjustment

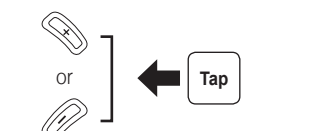

Battery Check

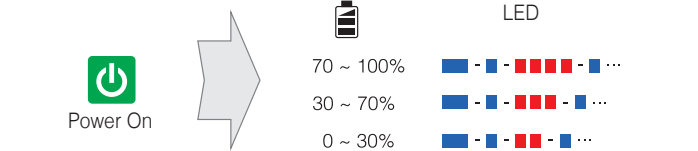

Phone, Music Pairing

Press and hold the **(+) Button** and **Center Button** for **10 seconds** when the **Tufftalk M** is turned off.

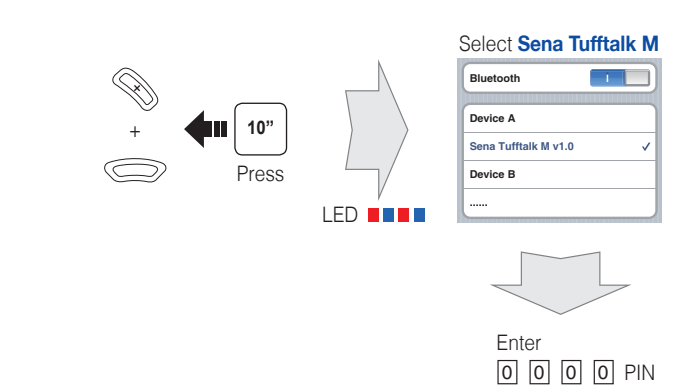

Music Operation

- ▶ / || 1" Press
- ◀ 1" Press
- ▶▶ 1" Press

Mobile Phone Call Making and Answering

- Answer: Tap
- End: 2" Press
- Voice Dial: 3" Press
- Speed Dial: 3" Press
- Reject: 2" Press

Intercom Pairing

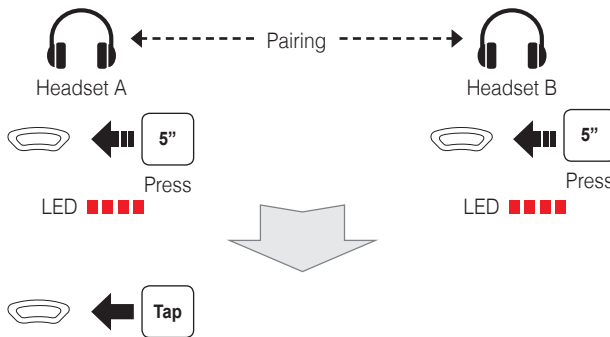

Intercom Start/End



Mesh Intercom On/Off

When **Mesh Intercom** is enabled, the **Tufftalk M** will automatically connect to nearby **Tufftalk M** users and allow them to talk to each other by pressing the **Mesh Intercom Button**.



Mesh Intercom Open Mesh

When **Mesh Intercom** is enabled, the headset will be in **Open Mesh™** (default: **channel 1**) initially.

Open Mesh Channel Setting

If the **Open Mesh** communication experiences interference because other groups are also using the **channel 1 (default)**, change the channel. You can select one of 1 to 9 channels.

Using the Button

Enter into the Channel Setting



Navigate between the channel
(1 → 2 → ... → 8 → 9 → Exit → 1 → ...)



Using the Sena Utility App

You can select the channel through the **Sena Utility App**.

Mesh Intercom Group Mesh

A **Group Mesh™** is a closed network of headsets that allows users to create, leave, join, or rejoin a group intercom conversation without pairing each headset.

Group Mesh Mesh Grouping

A private group can be made with up to 24 users.

Creating a Group Mesh

1. Users who want to create a **Group Mesh** can simultaneously press the **Mesh Intercom Button** for **5 seconds**.

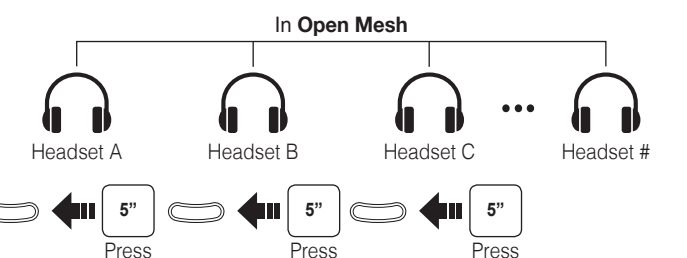

2. When headsets complete **Mesh Grouping**, headsets automatically switch from **Open Mesh** to **Group Mesh**, and users automatically create and join the **Group Mesh**.

Joining an Existing Group Mesh

1. Users (A, B) who want to join an **Existing Group Mesh** and one (C) of the users in the **Existing Group Mesh** simultaneously press the **Mesh Intercom Button** for **5 seconds**.

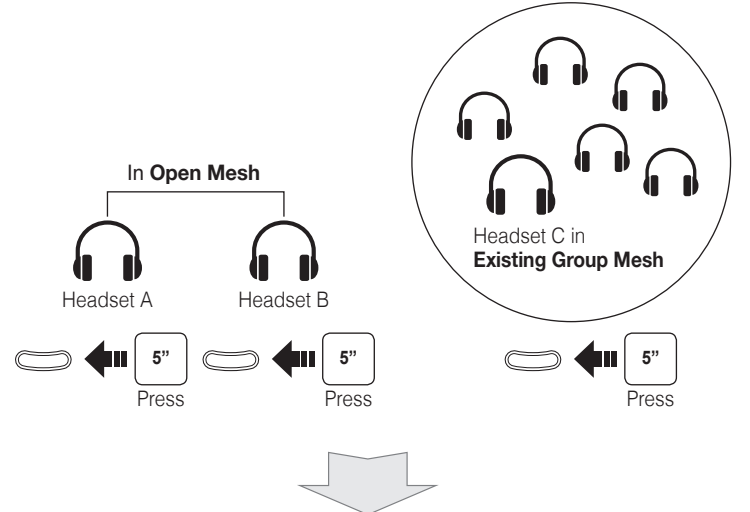

2. When headsets complete **Mesh Grouping**, headsets automatically switch from **Open Mesh** to **Group Mesh**, and users (A, B) automatically join the **existing Group Mesh**.

Mesh Intercom Reset Mesh

If a headset in an **Open Mesh** or **Group Mesh** resets the Mesh, they will automatically return to **Open Mesh (default: channel 1)**.



Microphone Mute/Unmute

The mute and unmute functions only work if **Bluetooth Intercom** or **Mesh Intercom** is on.

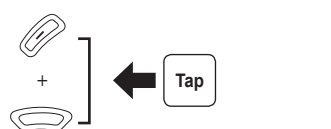

Radio On/Off



Radio Seek Stations

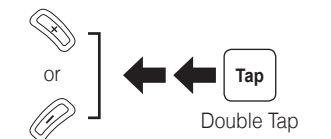

Radio Scan Up FM Band



Setting

Configuration Menu



Troubleshooting

Factory Reset

If you want to restore the headset to factory default settings, use the **Factory Reset** in the configuration menu. The headset automatically restores the default settings and turns off.

Fault Reset

If the headset is not working properly for any reason, push the **pin-hole reset button** located below the **Center Button**.

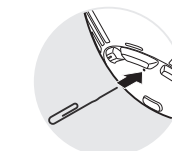

Quick Reference

Type	Operation	Button Command
Basic Function	Power on	Press the Center Button and the (+) Button for 1 second
	Power off	Tap the Center Button and the (+) Button
	Volume up/down	Tap the (+) Button or the (-) Button
Mobile Phone	Answer mobile phone call	Tap the Center Button
	End mobile phone call	Press the Center Button for 2 seconds
	Voice dial	Press the Center Button for 3 seconds
	Speed dial	Press the (+) Button for 3 seconds
Music	Play/Pause Bluetooth music	Press the Center Button for 1 second
	Track forward/back	Press the (+) Button or the (-) Button for 1 second

Quick Reference

Type	Operation	Button Command
Mesh Intercom	Mesh Intercom on/off	Tap the Mesh Intercom Button
	Channel setting	Double tap the Mesh Intercom Button
	Mesh Grouping	Press the Mesh Intercom Button for 5 seconds
Intercom	Reset Mesh	Press the Mesh Intercom Button for 8 seconds
	Intercom pairing	Press the Center Button for 5 seconds Tap the Center Button of any one of the two headsets
FM Radio	Start/End each intercom	Tap the Center Button
	FM radio on/off	Press the (-) Button for 1 second
	Select preset	Press the Center Button for 1 second
FM Radio	Seek stations	Double tap the (+) Button or the (-) Button
	Scan up FM band/stop scanning	Press the (+) Button for 1 second